

**Warning – use appropriate PPE (gloves) when performing maintenance on the Tethys.**

**Daily:**

- **Clean the lid seal.** The seal can be gently cleaned with a soft cloth soaked in a vinegar / water solution to remove any scale build up.

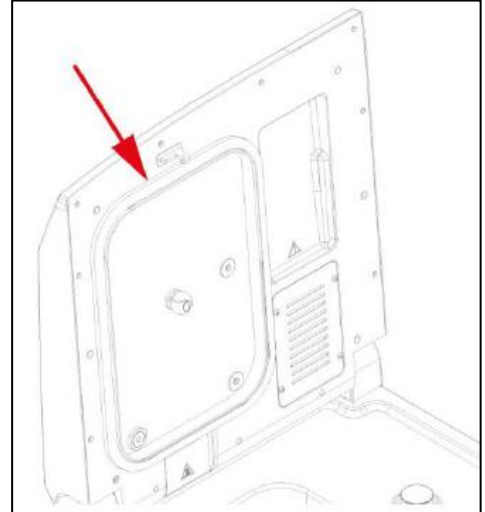

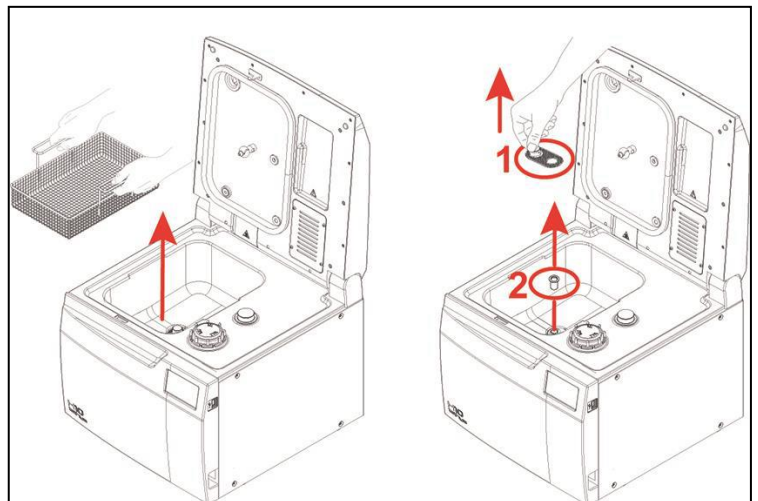

- **Clean the filters in the base of the washing chamber**

- Remove the basket from the washing chamber.
- Remove the filters (1) and (2) on the bottom of the chamber ensuring that possible residues do not drop inside the hole.
- Rinse thoroughly the parts that compose filters (1) and (2) under running water and reposition them in their housings.

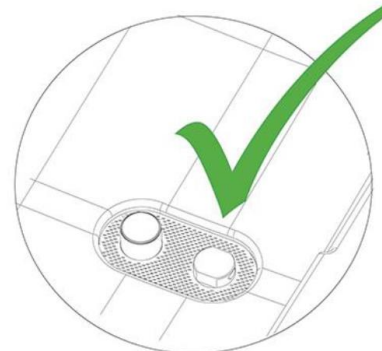
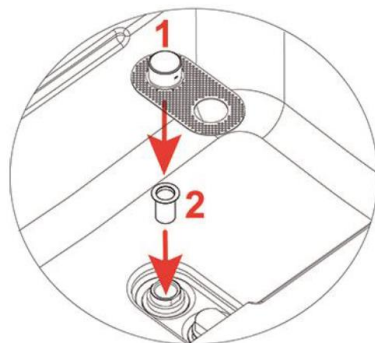

**NOTE**  
 CORRECTLY PLACE FILTERS (1) AND (2) BACK IN THEIR RELEVANT HOUSINGS.



**NOTE**  
 TO BE CLEANED, FILTER (1) DOES NOT HAVE TO BE COMPLETELY DISASSEMBLED. SHOULD FILTER BE DISASSEMBLED, RE-ASSEMBLE THE O-RING AS SHOWN IN THE FIGURE.

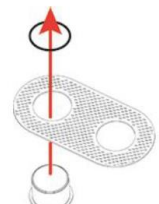

Mocom Tethys – Quick Guide #2	Page	2 of 2	
Operator maintenance	Version	1.1	
	Amend date	3/11/2020	

- Check the spinning ball nozzle on the lid can rotate freely (see below if it requires cleaning)
- Clean the washing chamber of any residual detergent with a soft cloth with a small amount of neutral detergent
- Clean any spilled salt or detergent from refilling of the unit and clean the outer surfaces of the unit. Using Denatured alcohol or detergents comprising a small percentage of sodium hypochlorite.

### Weekly:

- Remove the lid rotary nozzle with the Allen key supplied. Clean under running water and check for blockages. Clean the shaft it spins on to remove any fine grit build-up. **Once reassembled, check the nozzle is free to rotate.** Ensuring the shaft is kept clean, will increase the lifespan of this spinning nozzle assembly.

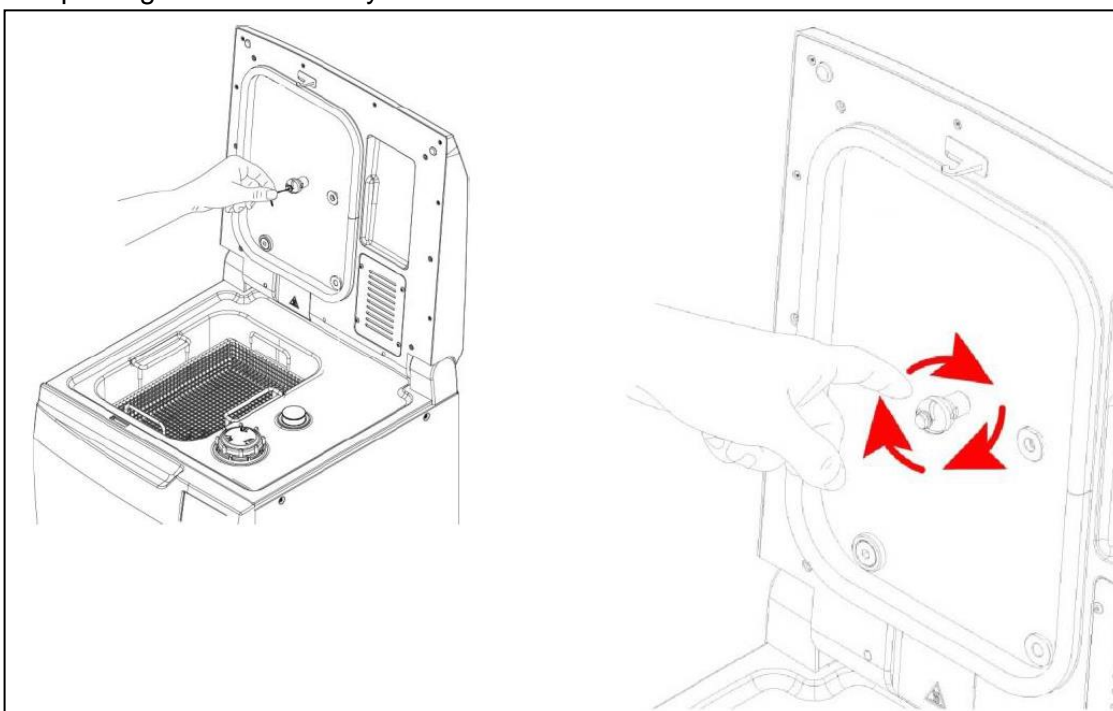

- Clean the washing chamber and trays. Scale can be removed with a solution of vinegar and water on a soft cloth.
- **Note:** Dark deposits in the base of the unit are caused by the ultrasonic process and are considered normal.
- Disinfect the external surfaces with a suitable agent

### Periodically:

- Service messages will appear periodically to remind you to conduct various maintenance tasks. These items will be addressed by your service technician at time of service, Press “OK” to accept these as they appear. Pressing  will only delay the message until the next cycle.

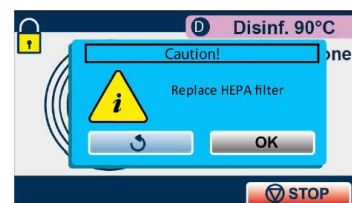

### Annually:

- Maintenance and Performance testing by authorized service technician to current standards.